

# PARKING ACCESS MAP OF AQUINAS COLLEGE

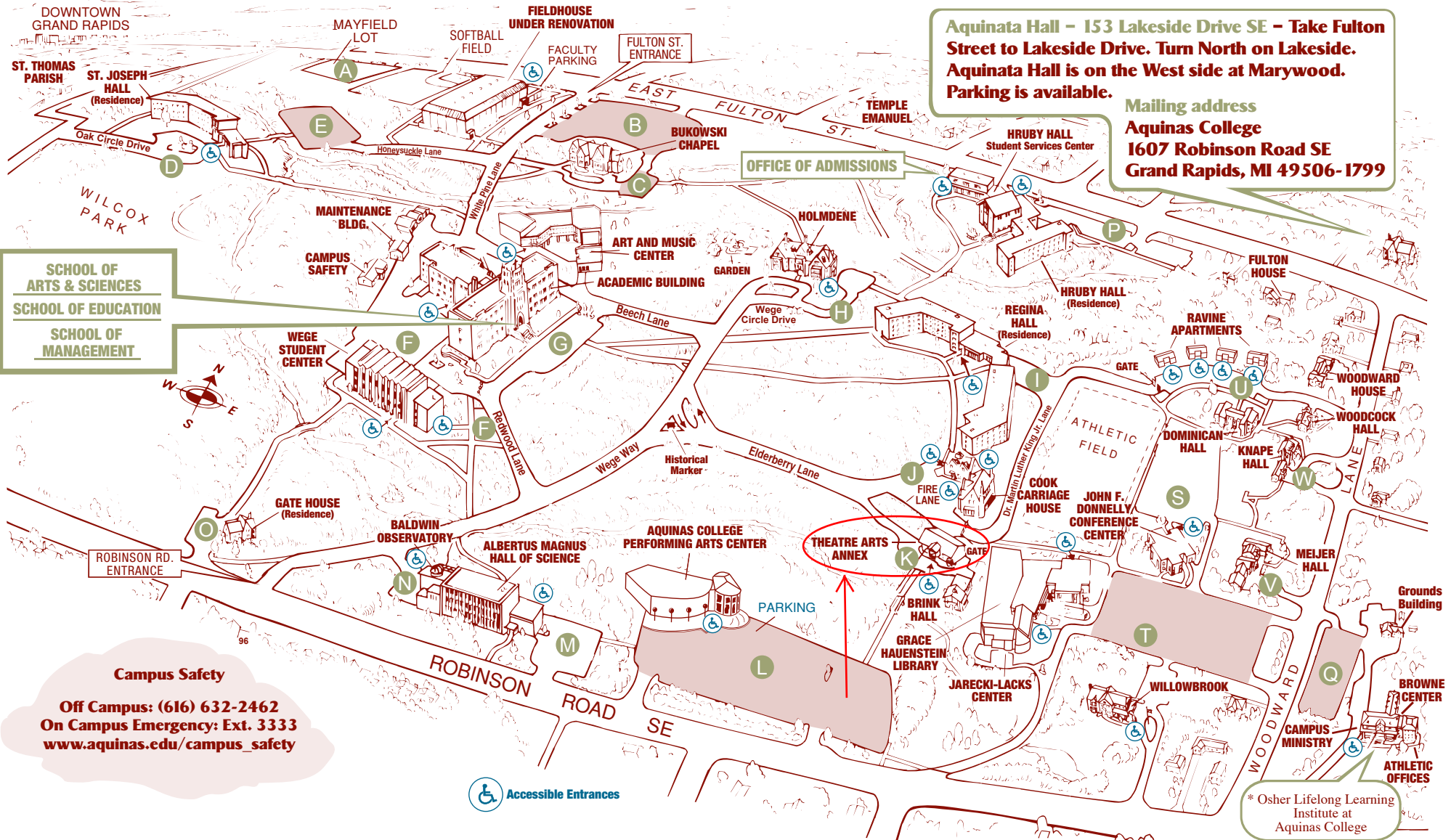

**Aquinata Hall – 153 Lakeside Drive SE – Take Fulton Street to Lakeside Drive. Turn North on Lakeside. Aquinata Hall is on the West side at Marywood. Parking is available.**

**Mailing address**  
**Aquinas College**  
**1607 Robinson Road SE**  
**Grand Rapids, MI 49506-1799**

**SCHOOL OF ARTS & SCIENCES**  
**SCHOOL OF EDUCATION**  
**SCHOOL OF MANAGEMENT**

**Campus Safety**  
**Off Campus: (616) 632-2462**  
**On Campus Emergency: Ext. 3333**  
**[www.aquinas.edu/campus\\_safety](http://www.aquinas.edu/campus_safety)**

Accessible Entrances

- Restricted (Special Permit Only)**
- D – Upper St. Joseph Hall Lot
  - F – Wege Lot
  - G – Academic Building Front Lot
  - H – Holmdene Lot
  - I – Regina Hall Lot
  - J – Carriage House Lot
  - K – Brink Hall Lot
  - N – West Science Lot
  - P – Hruby Hall Lot – West

- Restricted to Residents Only**
- A – Mayfield Lot (Gold Permit)
  - O – Gate House Lot (Orange Permit)
  - Q – Browne Center Lot/North Section (Brown Permit)
  - S – Donnelly Conference Center Lot (Green Permit)
  - U – Dominican Hall Lot (Blue Permit)
  - V – Meijer Hall Lot (White Permit)
  - W – Knappe Hall Lot (White Permit)

- General Parking (Commuter/Guests)**  
**No Parking 2 a.m. - 6 a.m.**
- B – Fulton Lot
  - C – Bukowski Chapel Lot
  - E – Lower St. Joseph Lot
  - L – Plymouth Lot (Noon to Midnight)
  - M – East Science Lot
  - Q – Browne Center Lot
  - T – Woodward Lot

**AQUINAS COLLEGE**  
 Makes all the difference in the world.

## AQ DIRECTIONS & INFORMATION

### From the North and South

Take US-131 to the I-196\* (Gerald R. Ford Expressway) East exit.  
Follow I-196 and exit at Fuller Ave.  
Turn right (south) on Fuller Ave. and drive to Fulton Street.  
Turn left. Follow Fulton Street to Aquinas College Field House.  
Turn right into the parking lot off of Fulton Street  
For the Admissions Office, continue past the main entrance and turn right into the Hruby Hall parking lot.

### From the West

Drive to either US-131 or I-196 and follow the directions found under "From the North and South."

### From Chicago

Take I-94 to Michigan and exit onto I-196 in the Benton Harbor/St. Joseph area.  
Follow directions found under "From the North and South."

### From the East

Take I-96 to the Cascade Road West exit (Exit 40A).  
Follow Cascade Road west for about three miles until it merges with Fulton Street.  
Veer left. Follow Fulton Street for about one mile.  
For the Admissions Office, turn left into the Hruby Hall parking lot.  
For the main entrance to the College, continue turn left into the Aquinas College Field House parking lot off of Fulton Street.

PLEASE NOTE: \*I-96 and I-196 are two different expressways in the Grand Rapids Area.

## TRANSPORTATION ALTERNATIVES

**Gerald R. Ford International Airport** <http://www.grr.org/>

As you leave the airport, turn north/right on Patterson Ave.  
At 28th Street, turn east/right to I-96 West.  
Take the Cascade Road West exit (40A).  
Follow Cascade Road west for about three miles until it merges with Fulton Street.  
Veer left. Our Fulton St. entrance is only a few blocks away, on your left.

**Amtrak** <http://www.amtrak.com/stations/grr.html>

Located on the corner of Market Ave. and Wealthy St.  
Go north/right on Market to Fulton St. then turn east/right.  
Our Fulton Street entrance is just over one mile away, on your right.  
Amtrak offers buy one ticket get one free for high school juniors and seniors.  
Visit the Amtrak Web site for more details.

**Greyhound** <http://www.greyhound.com/>

Located at 190 Wealthy St. S.W.  
Go east/right on Wealthy St. to Division Ave. and turn north/left.  
At Fulton St. turn east/right.  
Our Fulton St. entrance is only about one mile away, on your right.



## HOTEL INFORMATION

**Amway Grand Plaza Hotel\***  
Pearl at Monroe  
(818) 774-2000  
(800) 253-3590  
<http://www.amwaygrand.com>

**Days Inn\***  
310 Pearl St. N.W.  
(818) 235-7811  
(800) 325-2525  
<http://www.daysinn.com>

**Hilton - Airport\*\***  
4747 28th St. S.E.  
(818) 957-0100  
(877) 944-5866  
<http://www.hilton.com>

**Hampton Inn**  
Grand Rapids  
4981 - 28th St. S.E.  
(818) 958-9304  
(800) 428-7886  
<http://www.hamptoninn.com>

**Crowne Plaza\*\***  
5700 28th St. S.E.  
(818) 957-1770  
<http://www.crowneplaza.com>

**Comfort Inn\*\***  
4155 28th Street SE  
(818) 957-2080  
(800) 228-5150  
<http://www.comfortinn.com>

**Radisson - North**  
270 Ann St. N.W.  
(818) 383-8001  
<http://www.radisson.com>

\*Closest to Aquinas College  
\*\*Aquinas Discount Available

## ACADEMIC BUILDING

The Academic Building is located adjacent to the Arts and Music Center. Enter off of Fulton next to the Fieldhouse.

## ADMISSIONS OFFICE

The Admissions office is located inside the main entrance of Hruby Hall. (East of the Field House at 1760 Fulton St. SE. Just look for the green awning!)

## ART & MUSIC CENTER

The Art & Music Center is located adjacent to the Academic Building. Enter off of Fulton next to the Fieldhouse.

## GRACE HAUENSTEIN LIBRARY

The Grace Hauenstein Library is located just off of Robinson Rd. in the Jarecki Center for Advanced Learning Building. Free parking is available in the Woodward lot accessible from Woodward Lane.

## HOLMDENE

Holmdene is located in the center of campus. It is accessible from both Fulton Street and Robinson Road.

## PERFORMING ARTS CENTER

The Performing Arts Center is located off of Robinson Rd. It has parking available in the Plymouth Lot.

## WEGE STUDENT CENTER

The Wege Student Center is located adjacent to the Academic Building. Enter off of Fulton next to the Fieldhouse.